

### 1、Features:

- Emitting Color: RGB
- Lens Type: Water Clear
- Device Outline: 5.0x5.0x1.6 (unit:mm)
- RoHS compliant

### 2、Applications:

- Backlight for Mobile, Machine Vision, LCD Display
- Backlight in Dashboard and switch of Automotive
- Indoor LED lighting, Architectural Lighting

### 3、Outline Dimensions:

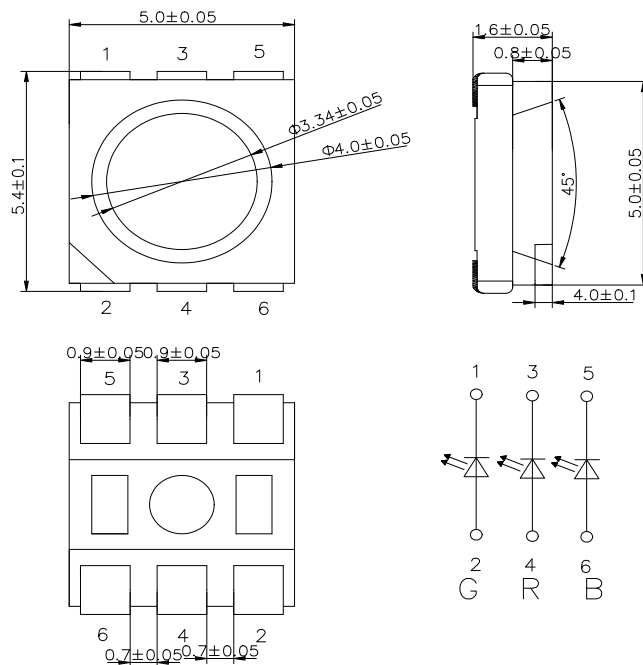

RECOMMEND PADLAYOUT

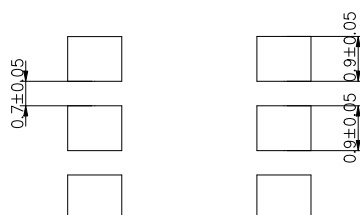



Part No.:JSL-5050RGB

4、Absolute maximum ratings (Ta = 25°C):

Parameter	Color	Symbol	Test Condition	Value		Unit
				Min.	Max.	
Power Dissipation	Red	Pd	---	---	60	mW
	Green				85	
	Blue				85	
Reverse Voltage	---	VR	IR = 30 $\mu$ A	5	---	V
Pulse Current	---	IFp	Duty=0.1, 1kHz	---	100	mA
Forward Current	---	IFm	---	---	25	mA
Operating Temperature	---	Topr	---	-40	+85	°C
Storage Temperature	---	Tstr	---	-40	+100	°C

5、Electrical and optical characteristics (Ta = 25°C):

Parameter	Color	Symbol	Test Condition	Value			Unit
				Min.	Typ.	Max.	
Forward Voltage	Red	VF	IF = 60mA	1.8	---	2.5	V
	Green			2.8	---	3.5	
	Blue			2.8	---	3.5	
Reverse Current	---	IR	VR = 5V	---	---	30	$\mu$ A
Wavelength	Red	Tc	IF = 60mA	619	---	631	nm
	Green			515	---	530	
	Blue			465	---	475	
Luminous Intensity	Red	Iv	IF = 60mA	400	700	---	mcd
	Green			1000	1500	---	
	Blue			300	450	---	
Viewing Angle	---	2 $\theta$ 1/2	IF = 60mA	---	120	---	Deg.

### Typical electrical/optical characteristic curves:

