

## Part No.: JSL-3W-UB440

### Features:

- Highest Flux Blue
- High reliability and Very long operating life (up to 100K hours)
- Low voltage DC operated
- More Energy Efficient than Incandescent and most Halogen lamps
- NO UV
- Superior ESD protection

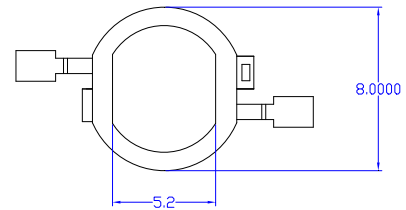
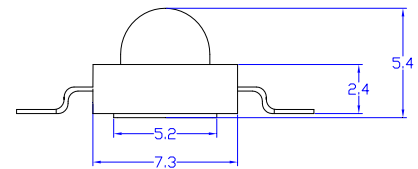
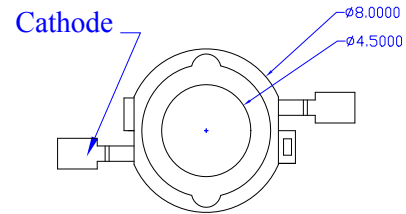

### Typical Applications:

- Reading lights(car,bus,aircraft)
- Portable(flashlight,bicycle)
- Automotive Exterior(Stop-Tail-Turn, CHMSL,Mirror Side Repeat)
- Decorative

### NOTE:

- All dimensions are millimeter.
- Tolerance is  $\pm 0.25\text{mm}$  unless otherwise noted

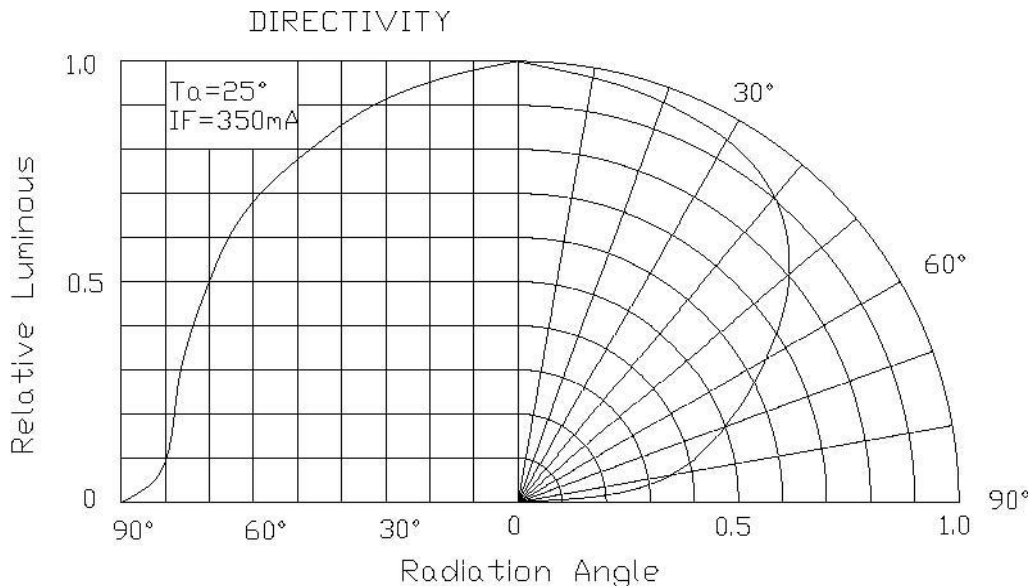



# Ningbo Junsheng Electronics Co.,LTD.

Part No.: **JSL-3W-UB440**

## Absolute maximum ratings (Ta = 25°C)

| Parameter                | Symbol            | Test Condition | Value                   |      | Unit |
|--------------------------|-------------------|----------------|-------------------------|------|------|
|                          |                   |                | Min.                    | Max. |      |
| DC Forward Current       | I <sub>F</sub>    | ----           | ----                    | 700  | mA   |
| Peak Pulse Current       | I <sub>peak</sub> | Duty=0.1, 1kHz | ----                    | 1000 | mA   |
| Power Dissipation        | P <sub>d</sub>    | ----           | ----                    | 3.0  | W    |
| LED Junction Temperature | T <sub>j</sub>    | ----           | ----                    | 120  | °C   |
| Operating Temperature    | T <sub>opr</sub>  | ----           | -25                     | +100 | °C   |
| Storage Temperature      | T <sub>str</sub>  | ----           | -40                     | +120 | °C   |
| ESD Sensitivity          | ---               | HBM            | 8000                    | ---- | V    |
| Soldering Temperature    | ---               | ----           | 260°C for 5 Seconds max |      |      |

## Electrical and optical characteristics (Ta = 25°C)

| Parameter           | Symbol         | Test Condition         | Value |      |      | Unit |
|---------------------|----------------|------------------------|-------|------|------|------|
|                     |                |                        | Min.  | Typ. | Max. |      |
| Forward Voltage     | V <sub>F</sub> | I <sub>F</sub> = 700mA | ---   | 3.6  | 4.0  | V    |
| Luminous Flux       | Φ <sub>v</sub> | I <sub>F</sub> = 700mA | 20    | 30   | ---- | lm   |
| Viewing Angle       | 2θ 1/2         | I <sub>F</sub> = 700mA | ----  | 120  | ---- | Deg. |
| Dominate Wavelength | λ <sub>d</sub> | I <sub>F</sub> = 700mA | 440   | ---- | 450  | nm   |